

Enter Tool Specifications

Quantity

Number of Flutes

Teeth Type

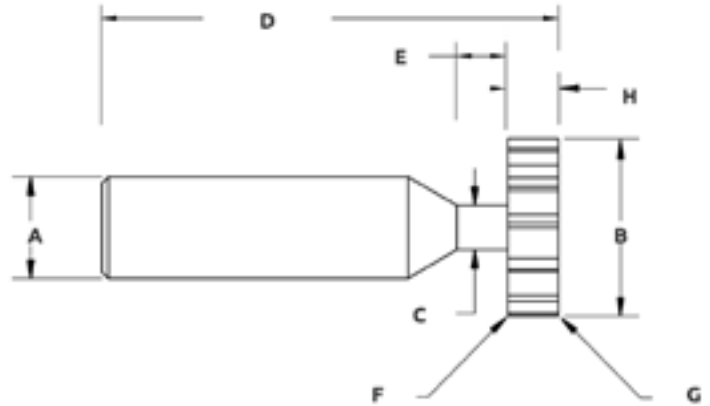

| | | Tolerance |
|----------------------|----------------------|----------------------|
| (A) Shank Diameter | <input type="text"/> | <input type="text"/> |
| (B) Cutting Diameter | <input type="text"/> | <input type="text"/> |
| (C) Neck Diameter | <input type="text"/> | <input type="text"/> |
| (D) Overall Length | <input type="text"/> | <input type="text"/> |
| (E) Neck Length | <input type="text"/> | <input type="text"/> |
| (F) Radius/Chamfer | <input type="text"/> | <input type="text"/> |
| (G) Chamfer/Radius | <input type="text"/> | <input type="text"/> |
| (H) Cutter Width | <input type="text"/> | <input type="text"/> |

Enter Tool Options

Coating

Fullerton Series

Competitor Series

Direction of Cut

Material Machined

Work Holder

Application

Enter Contact Information

Contact Name

Email

Distributor Name

Distributor Contact

Company

Phone

RFQ